

# Quick Guide

## Step 1

### Installation video guide

Scan the QR code on the right and follow the video instructions to install it.



## Download the ANTHBOT APP

ANTHBOT APP can be downloaded from Apple APP Store or Google Play, or scan the QR code to download and install ANTHBOT APP. After downloading, please register an account, log in and follow the APP prompts to add the device to start using.  
Note: Please make sure the network frequency band connected to the device is 2.4GHz

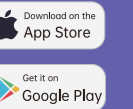

## Step 2 Find location

### 1 Find an unobstructed area

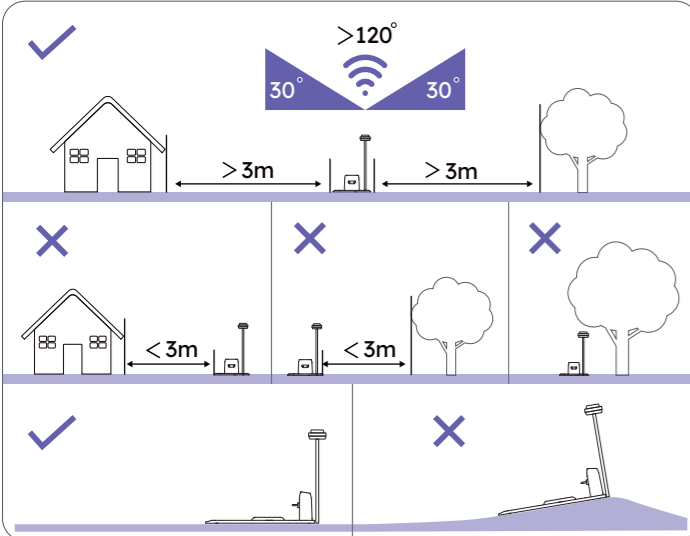

**Warning:** Ensure the installation location has WiFi signal coverage (2.4GHz).

### 2 Place charging station

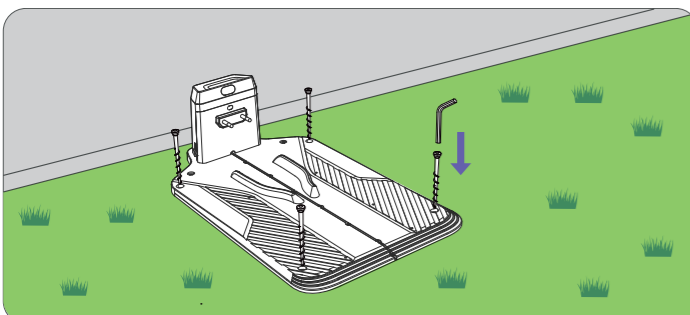
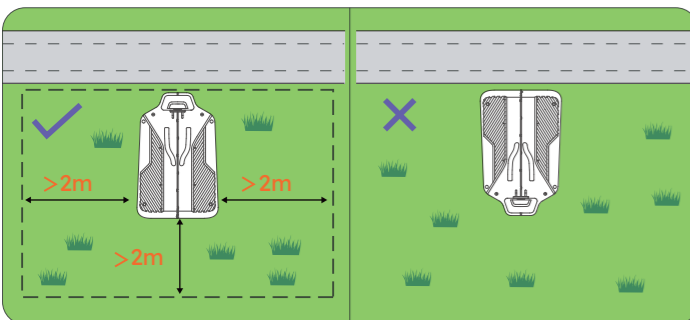
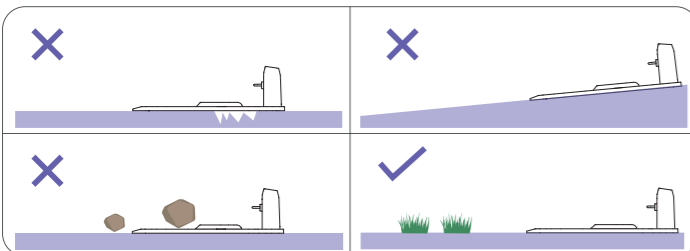

## Step 3 Installation

### Installation and power supply

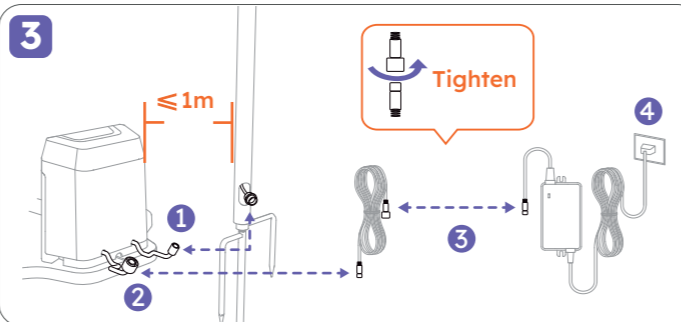
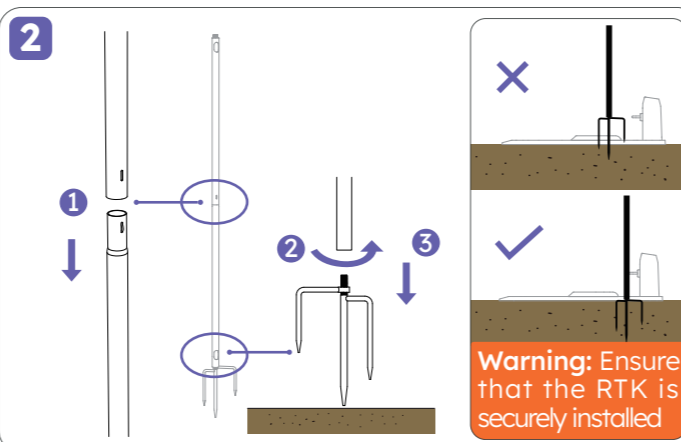
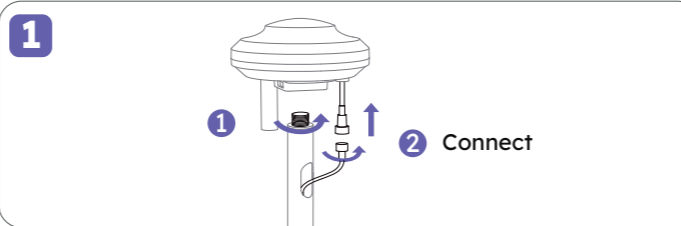

### Check signal lights

Connect a temporary power source and look for an installation area with a stable signal (green indicates that the signal is stable).



Move the device to the location and turn it on. If the GPS on the display is always on (it takes about 3 minutes to wait), it means that the location meets the installation requirements.

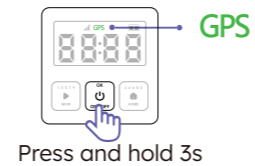

**Warning:** The indicator light cannot stay green all the time. Please try again after changing the installation location.

## Step 4 Operation

### APP operation

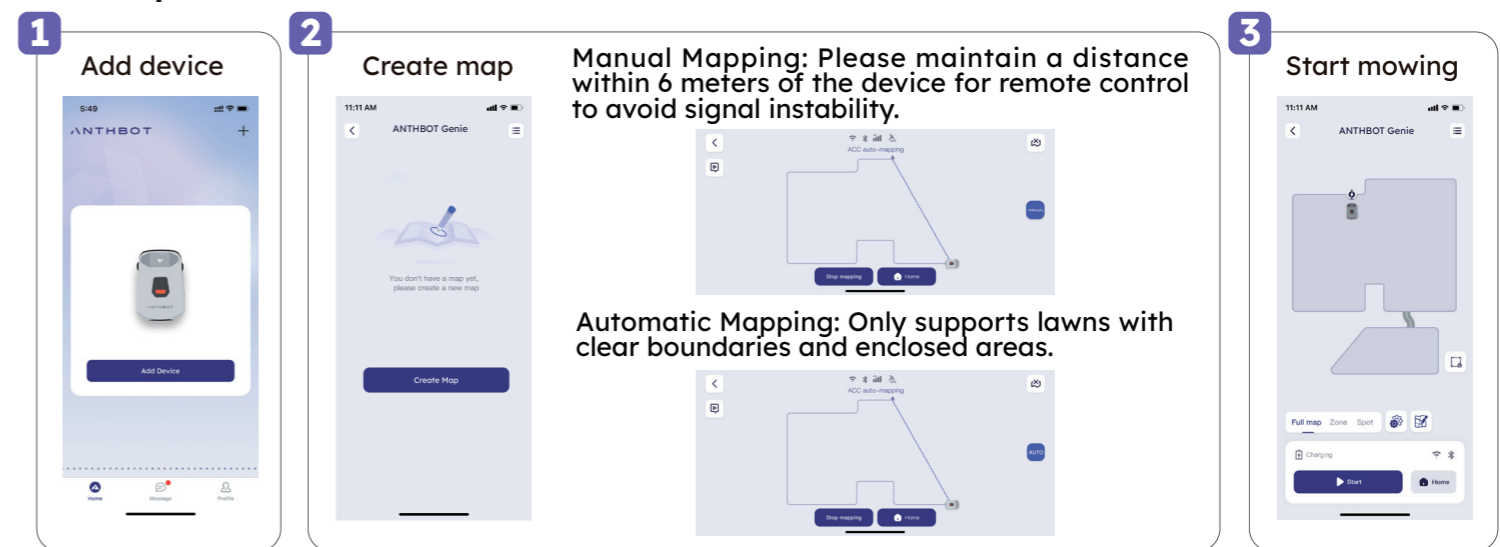

**Warning:**

1. Please create a map before starting the task
2. Make sure the RTK base station indicator light is green and the host GPS signal icon is on before operating.
3. Make sure to start from the charging station before creating a map.
4. If the RTK base station is tilted or moved after the map is created, you need to recreate the map.
5. Please create a virtual restricted area in the application to prevent the device from entering the dangerous area.

### Host operation

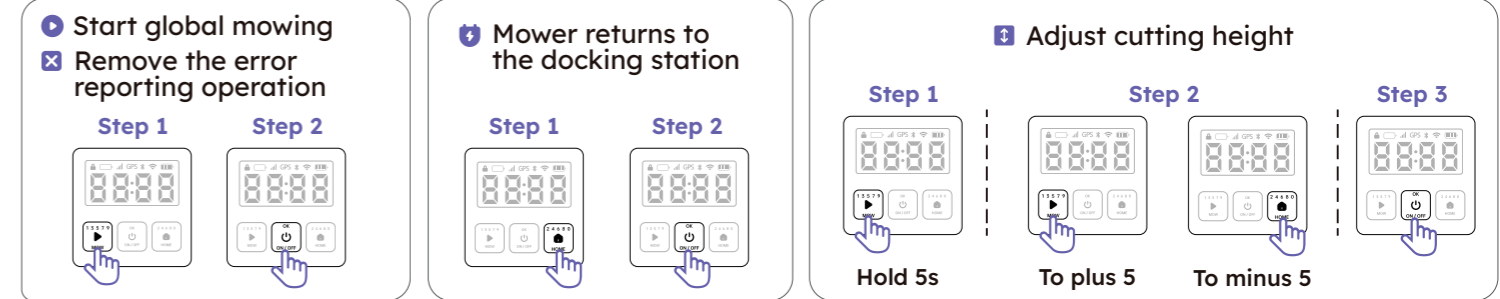
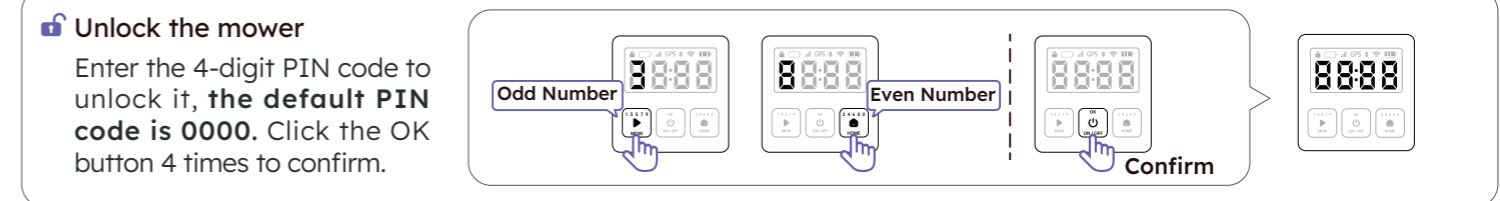

User manual  
Please refer to the user manual for more details



Welcome to join our Facebook Group for a discussion

