

IMPERIAL

Toilet Instruction Guide

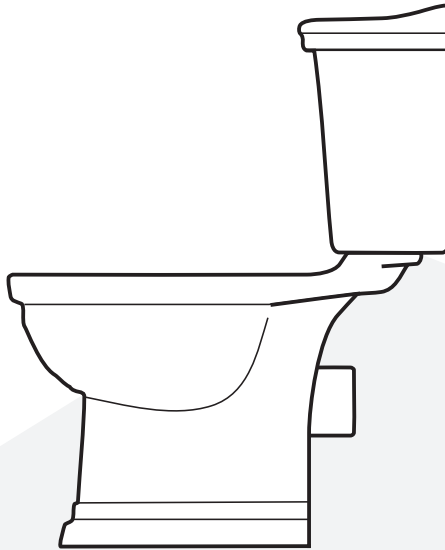

Important Information:

Please check the products for transport damage and that contents are complete before installation.

Consult a qualified plumber if you have any problems installing this product.

Complaints made following installation regarding the above cannot be accepted.

Installation Guide

Thank you for purchasing this product.

These instructions relate to our close coupled, high level and low level toilets.

Before you start check you have the necessary tools for installation.

Before you begin:



Always handle our products with care and attention.

Ceramic products are brittle, and may chip, crack or break if not handled carefully. Broken ceramic is extremely sharp.

Take care not to over tighten screws and fittings. Over tightening may lead to breaks or chips in the ceramic.

Before installing the product, please inspect for damage incurred during transport.

Imperial can not take responsibility for damaged products after or during their installation.

We recommend that the guidance of a qualified plumber is sought throughout the installation process.

Always observe the plumbing and building regulations in the area the product is being installed in.

Imperial reserves the right to amend the design of its products without notice, as specified in the company catalogue.

Tools Required

The following tools are necessary for the installation of this product.

Imperial would once again recommend that a qualified plumber carry out the installation of this product.



Spanner



Silicone Sealant



Drill

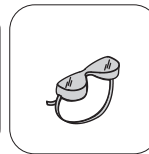

Safety Glasses

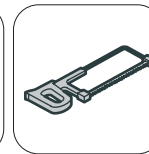

Hacksaw



Pencil

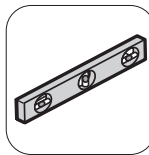

Spirit Level



Basin Bolts Kit



PTFE Tape

Flush valve parts

1. Flush valve

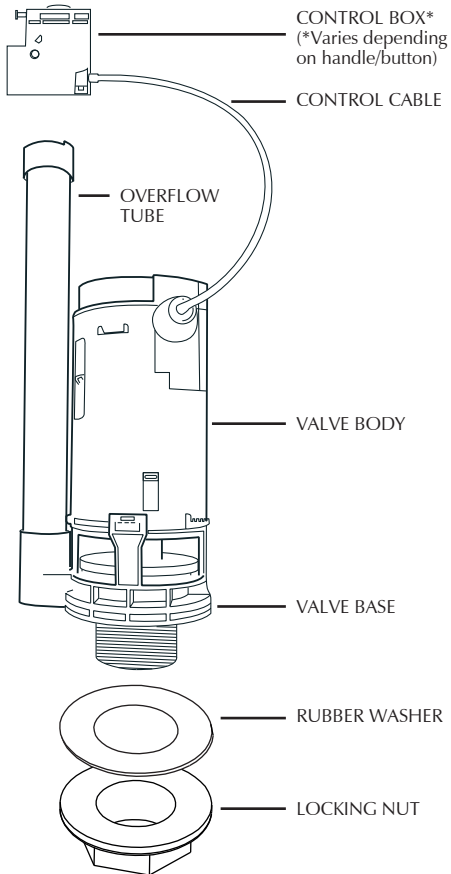

2. Lever

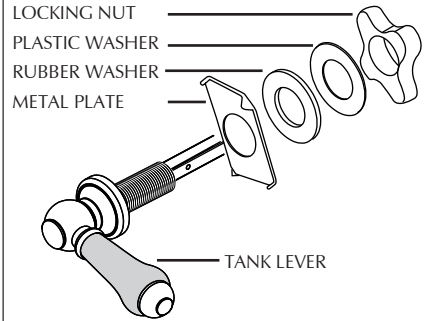

3. Push button

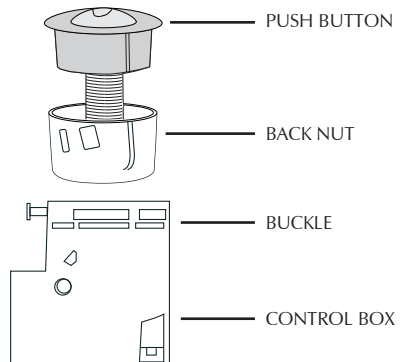

Adjustment of flush volume

Adjustment of FULL FLUSH volume:

Full adjustor down – full flush volume increases.

Full adjustor up – full flush volume decreases

4

overflow tube
trim level

203mm

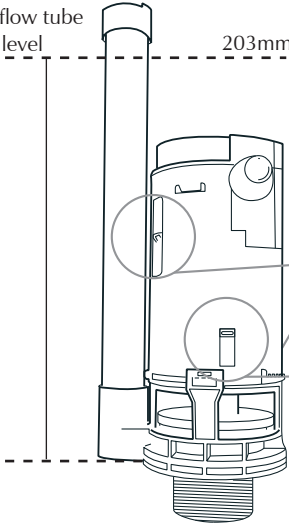

1

FULL ADJUSTOR

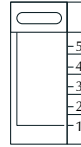

2

FLOAT CUP

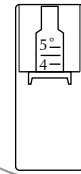

3

HALF ADJUSTOR



Adjustment of HALF FLUSH volume:

Float cup down – half flush volume increases

Float cup up – half flush volume decreases

NOTE: Press the clip to adjust the half adjusting float up and down

Half adjustor up - half flush volume decreases

Half adjustor down - half flush volume increases

SETTINGS FOR YOUR TOILET

		CC	LL	HL
1	Flush adjustor	½	1	n/a
2	Float cup	0	2	n/a
3	Half adjustor	2	1½	n/a
4	Overflow trim	203mm	203mm	n/a

⚠ NOTE: Please refer to instruction booklet provided with your product or the label on a lid of the cistern for correct settings specific to your chosen wc suite.

Install valve into tank

Mount the valve into the cistern.
The flexible cable should always be allowed to bend gently without sharp changes in geometry.

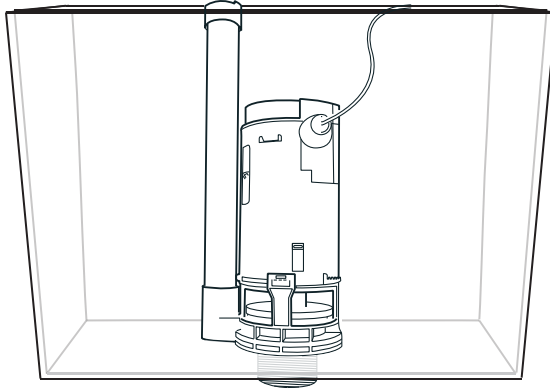

How to install a lever

Please ensure that your cistern has the water inlet and flush valve installed.
Insert nylon sleeve into cistern hole. Secure from the rear using metal plate, washers and back nut. Ensure back nut is fastened tightly to avoid handle coming loose. The hole in the cistern may be in the front or the side.

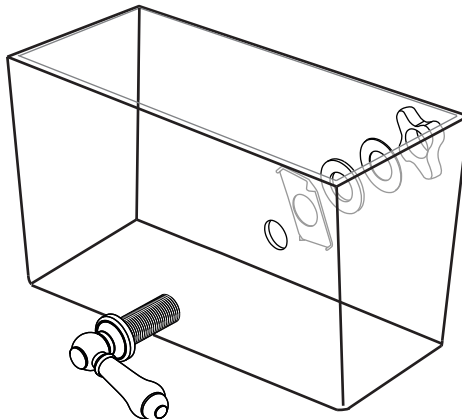

How to install a push button

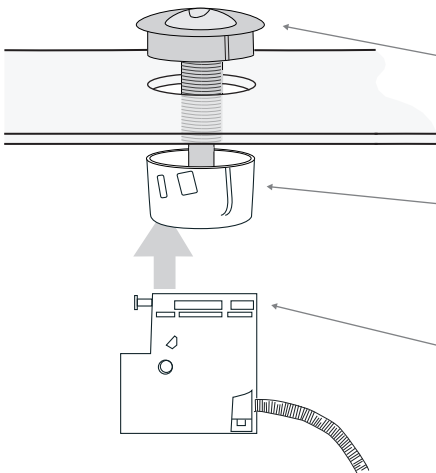
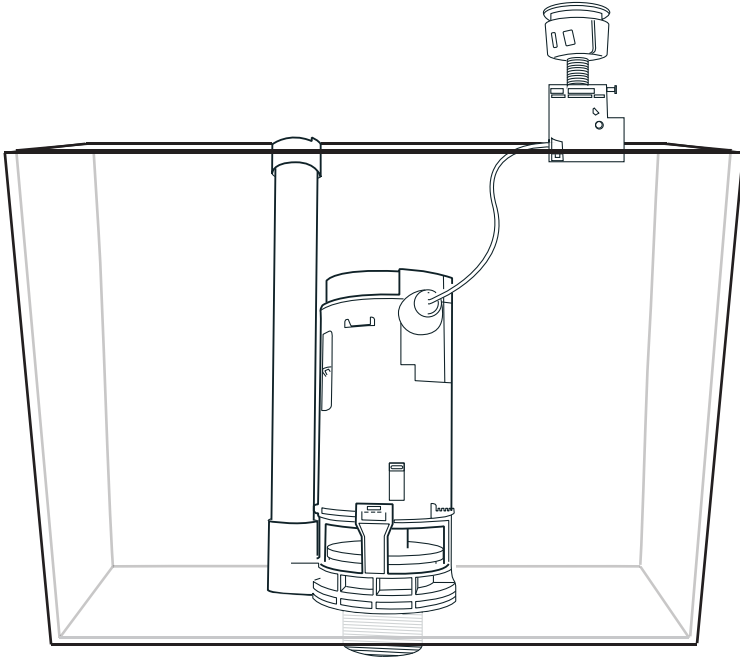

Place the push-button into the cistern lid hole. When done properly the button will sit flush with the cistern without force.

Secure the push-button to the cistern lid by hand tightening the cap provided. Ensure the button is attached tight enough to prevent movement.

Connect the control box to the push-button by pushing together. An audible 'click' will sound confirming that the connection has been made.

How to install inlet valve

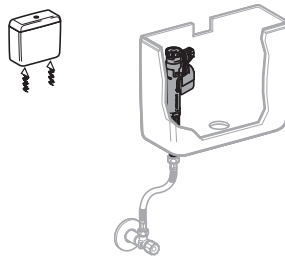

0,01 - 1 MPa
(0,1 - 10 bar / 1,5 - 145 psi)

1

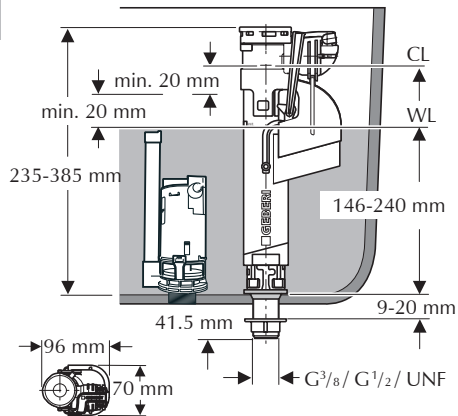

2

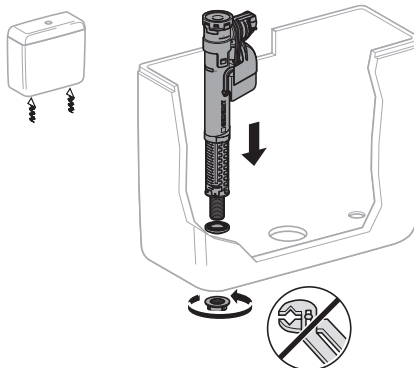

Installing a close-coupled toilet

3



4

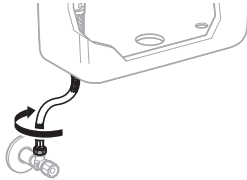

5

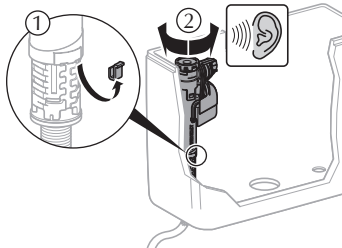

6

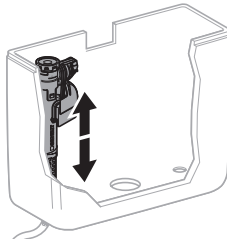

7

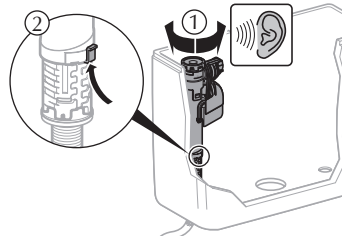

Installing a close-coupled toilet

- ⚠ Carefully measure and plumb in all necessary pipework prior to installing the toilet. Ensure that you have a clear space within which to work. Ensure that the installation of flush and filling valve is complete as instructed, and that all fittings are tested and in working order. Insert the cistern bolts and locate the cistern correctly onto the pan as shown below. Once correctly positioned tighten wing nuts to ensure a secure connection to the WC pan. Once the cistern is secured to the pan offer the toilet up to the desired position. Ensure that the cistern sits flat against the wall and is level and the foot of the pan is perpendicular to the wall using a pencil to mark around the foot of the pan and the fixing holes in both foot and cistern.

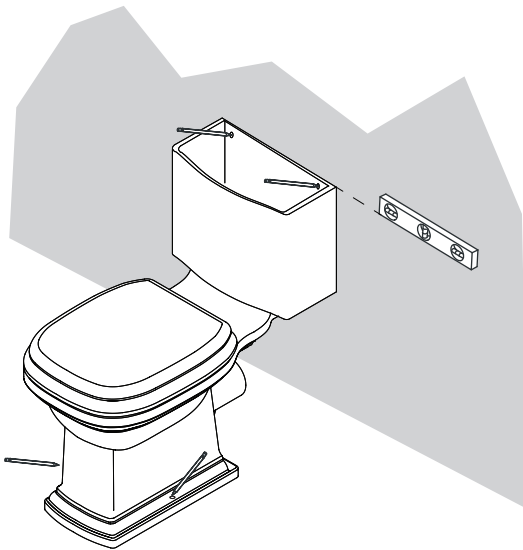

Cistern fixing styles

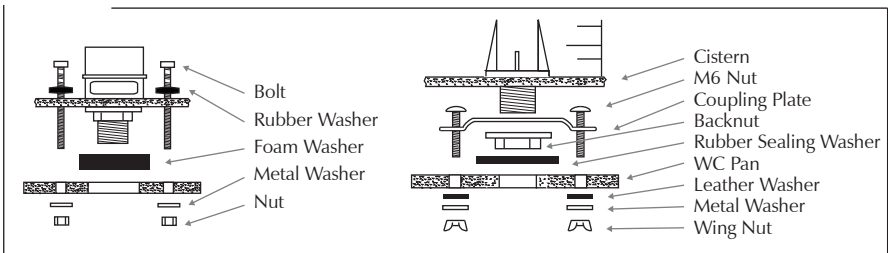

Installing a close-coupled toilet (continued)

- ⚠ Carefully measure and install all necessary pipework prior to installing the toilet. Ensure that you have a clear space within which to work. Remove the assembled toilet pan from the wall and drill the marked points. Insert the 8 x 60mm plugs for the floor fixing (solid floors only). Fixings for the cistern are not provided so please use suitable fixings for your wall type. Re-position the pan upto the wall and attach the waste pipe. Connect the water inlet pipe to the inlet valve. It may be advisable to use PTFE tape to help create a watertight seal between the inlet valve thread and the connecting nut. Secure the toilet pan to the floor/wall by using the fixings supplied/selected. It is advisable to run a bead of silicon around the joint between the WC outlet pipe and the waste pipe to ensure a good seal. Assemble the flush handle to cistern lid and place into position. Once you are satisfied that the pan has been installed correctly and the fixings are adequately tightened switch on the water supply to the inlet valve and once the cistern is filled operate the flush cycle.

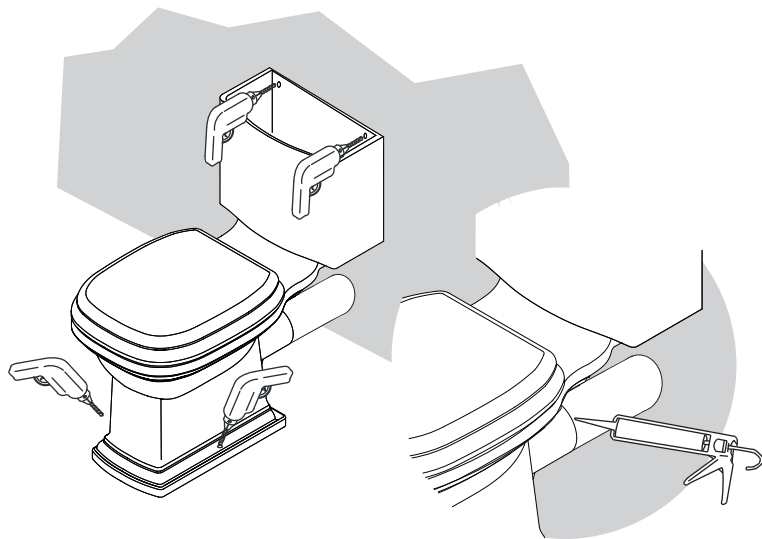

- ⚠ Operate the flush cycle a few times and continually check carefully for signs of leaks from the inlet valve or toilet outlet if no leaks are evident, your toilet installation is complete.

Installing the siphon (high level toilets only)

Fit the siphon with a rubber washer inside cistern. Secure with 1.1/2" BSP back nut. Before fixing the cistern to the wall, it is advisable to fit remainder of internal components. Hand tighten cap nut.

Fig1: Inserting the Outlet Siphon into the Cistern (below) and Siphon assembly (below right).

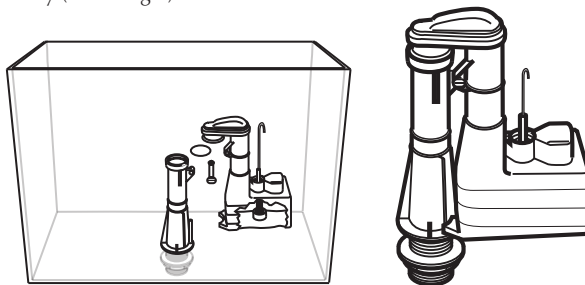

The white downleg connects to the orange bell housing by sliding upwards and securing with yellow linchpin (as pictured).

Installing the filling valve (high level toilets only)

(Refer to Filling Valve diagram opposite as a guide to this section)

Insert the float spiral stem horizontally between the two jaws and twist to engage the upper jaw.

Fit the filling valve ensuring the rubber washer is on the inside of the tank.

Tighten the back nut with spanner, tighten a further three-quarter turn.

Do not overtighten.

Insert the correct flow combined filter restrictor into the threaded tail.

Fit anti-siphon securely by pushing firmly into position, ensuring clips are fully engaged over mating parts.

Check anti-siphon assembly is held securely by retaining nut and filler tube hangs freely.

Fig 3. Inserting the 'Side Entry Filler Valve' to the cistern.

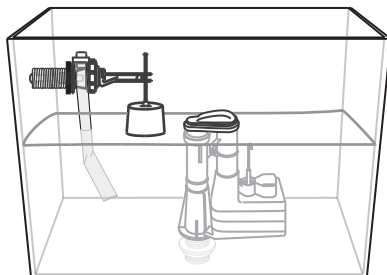

Installing the filling valve (high level toilets only) continued

Adjust water level by twisting float up or down.

⚠ Important: for new build/installations: Before turning water on, ensure that one cold water tap is open so that dirt and loose particles in the pipe work are flushed through the tap.

To rotate or remove: unscrew retaining nut, pull anti-siphon vertically and rotate or replace anti-siphon assembly.

Tighten up retaining nut and ensure raised lip is retained.

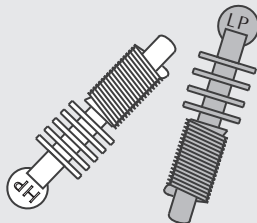
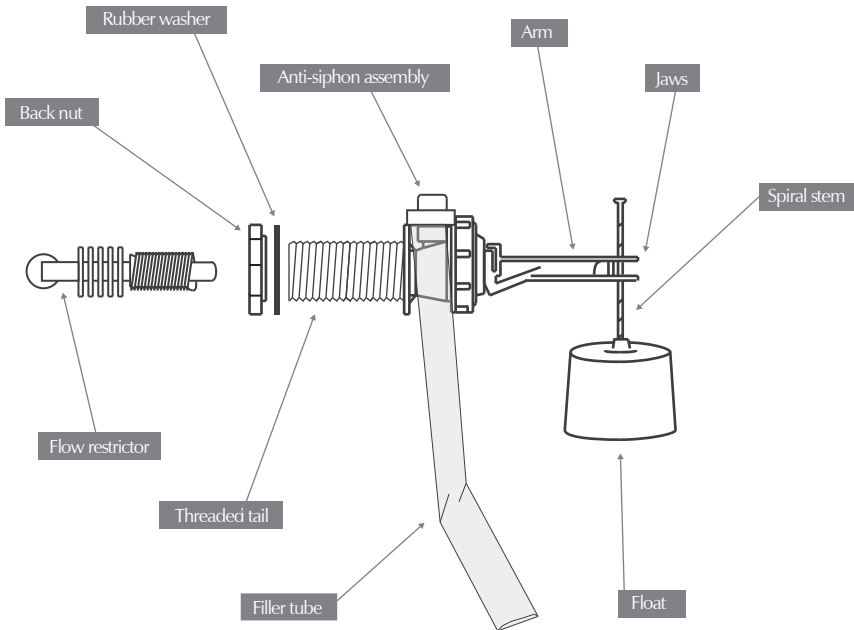

Depending on the water supply pressure, you will need to apply the appropriate restrictor to the threaded tail. Below 1 bar (14 psi) No restrictor.

Between 1-4 bar (14 - 60 psi) L.P. Restrictor (Blue)

Over 4 bar (60 psi) H.P. Restrictor (White)

Please ensure the correct water pressure is maintained using restrictors in relation to the table above. It is essential that the overflow rate must be greater than the infill rate product.

Installing the filling valve (high level toilets only)

Install Pan As Directed In Installation Instructions Provided With The Ceramic Product.

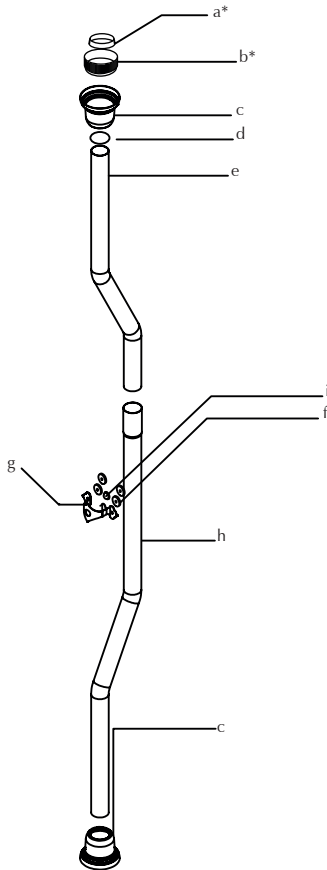

	Parts	qty
a	Rubber Washer	X1
b	Plastic Nut	X1
c	Shroud	X2
d	Rubber O ring	X1
e	Upper pipe	X1
f	Rubber Washer	X4
g	Domed Metal Bracket	X1
h	Lower Pipe	X1
i	Rubber Buffer	X1

* supplied with siphon pack

Installing the filling valve (high level toilets only) continued

Install cistern and fittings as described in ceramic installation instruction. Assemble the components onto the top pipe as shown below and tighten the plastic nut onto the siphon.

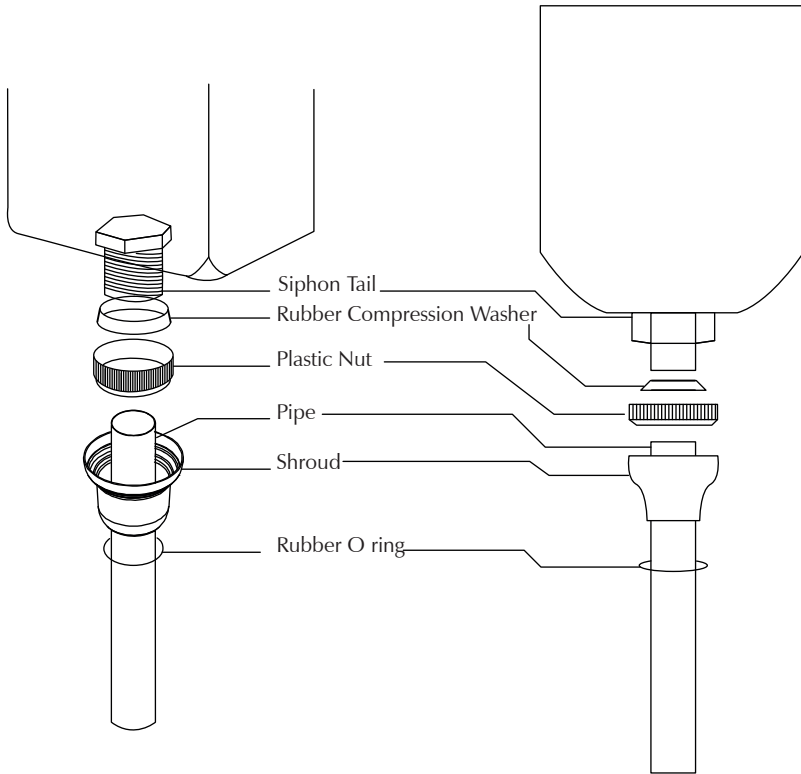

If necessary the pipe can be trimmed to suit. If trimming please ensure that a suitable saw is used and all burrs are carefully removed with a file.

Attachment of cistern to pan (multi pan)

Install the cistern and fittings as directed in ceramic instructions.

Install pipe to cistern as described previously. Assemble the translucent plastic (neoprene) grommit with the black donut shaped sealing gasket.

Insert the grommit from the flat side of the gasket so that the largest flange locates firmly on the rebate inside the gasket.

Insert the end of the flushpipe through the O-ring then the decorative shroud and then through the centre hole located on the top of the ceramic cover plate.

Then insert the flush pipe through the plastic grommit from the flat side of the sealing gasket.

 Do not push the flushpipe beyond the end of the three exposed flanges of the grommit. To do so will affect the water flow (i).

Secure the cover plate over the pipe and gasket assembly using the decorative bolts and wing nuts supplied. Care should be taken not to over-tighten the wingnut (ii).

The decorative shroud should be fixed in position on the ceramic cover plate of the pipe

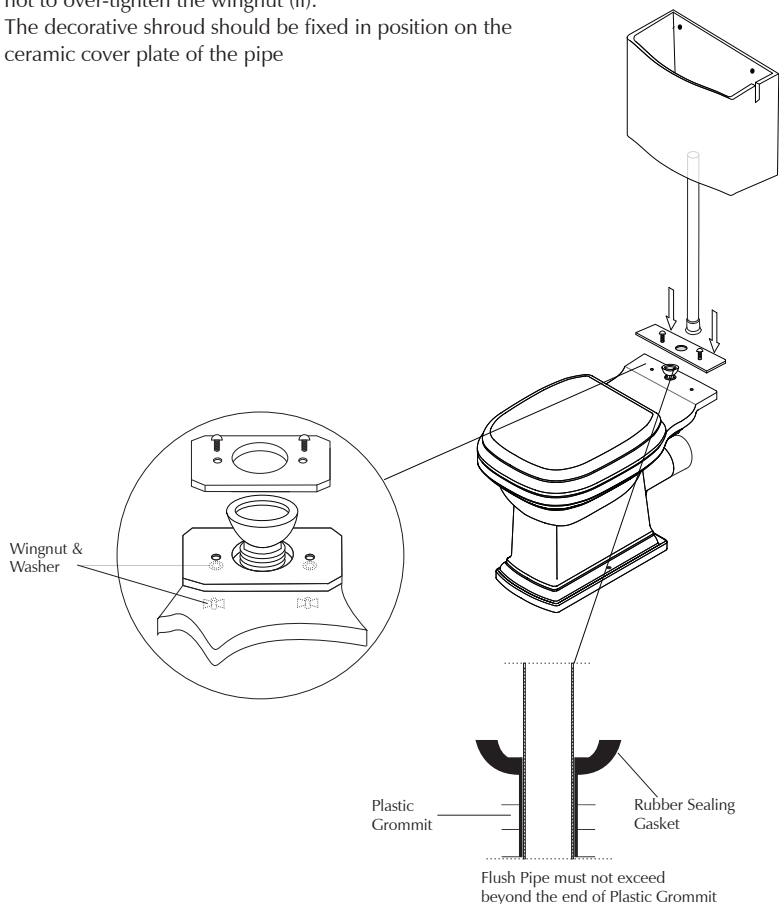

⚠ Move the pan into the installation area and mark where the drilling hole are located as pictured below.

Attach the conversion plate to the pan as pictured (below left).

Fit the flush pipe in place but do not yet secure.

Secure the toilet pan to the floor by using the fixings supplied/selected.

It is advised to run a bead of silicon around the joint between the WC outlet pipe and the waste pipe to ensure a good seal.

Secure the flush valve to the pan and cistern tightly and fit the water supply to complete the installation.

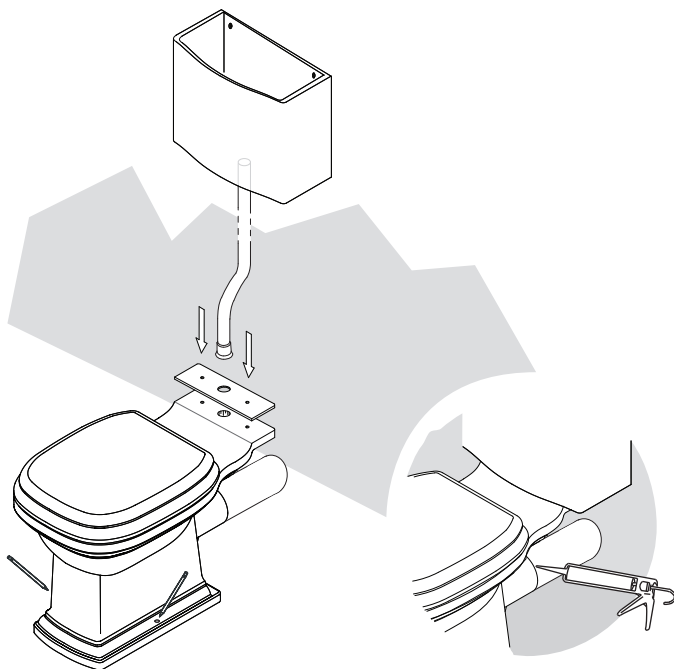

⚠ Operate the flush cycle a few times and continually check carefully for signs of leaks from the inlet valve or toilet outlet if no leaks are evident, your toilet installation is complete.

Care and Cleaning instruction

Looking after your toilet

The glazed finish on your sanitaryware should be cleaned after use by applying a little cream type cleaner. Apply using a sponge or damp cloth and rinse thoroughly with clean water. Cleaners containing abrasive materials should be avoided.

Bathroom vanity furniture can be wiped over with a damp cloth and dried with a soft duster. The use of polish containing silicone or any abrasive materials can damage the wood finishes. Natural wax polishes should be used sparingly.

.....

.....

.....

.....

.....

.....

.....

.....

.....

.....

.....

.....

.....

.....

.....

.....

.....

.....

.....

.....

.....

.....

.....

.....

.....

.....

IMPERIAL

The Imperial Bathroom Company
England

www.imperial-bathrooms.co.uk

Tel: +44 (0)1922 743074, Fax: +44 (0)1922 743180

Email: sales@imperial-bathrooms.co.uk